



Comhairle Cathrach & Contae Phort Láirge
Waterford City & County Council

27th March, 2024

MQ/LH/G456

Planning Department,
Waterford City & County Council,
Menapia Building,
The Mall,
Waterford.

Re: Letter of Consent to Making of Planning Application by Monaco Developments Ltd.

To Whom it concerns,

The Property Management Department of Waterford City & County Council hereby consents to the making of a Planning Application by Monaco Developments Ltd. for the Greenway Park Development Ballinaneeshagh, Waterford on lands owned by Waterford City & County Council, as per the attached map.

This letter is not consent to commence any works but is purely for planning purposes only.

Please note if planning permission is granted, please revert to me re Land disposal terms.

Yours sincerely,

Mary Quigley,
Administrative Officer,
Property Management Department,
Menapia Building,
The Mall,
Waterford.

URBAN PLACE MAP

CJFA
ARCHITECTS
C.J. Falconer
+ Associates
ARCHITECTS

St. Patrick's House, Newtown, Waterford, X91-RR76, Ireland.
+353 (0)51 874188 mail@cjfa.ie www.cjfa.ie

Ordnance Survey Ireland Licence
No. AR0005424 © Government of Ireland
Map Ref. No. 4809-C

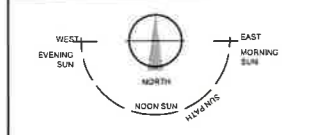

PREPARED BY C.J. Falconer + Associates
Architects
DRAWING NO. - 0100 SITE LOCATION MAP

SITE AREA SUBJECT TO THIS APPLICATION
OUTLINED IN RED: **6.99 Ha**

SITE AREA IN CONTROL OF THE
APPLICANT/SUBJECT TO SEPARATE
APPLICATION **2.15 Ha**

WAYLEAVE WITHIN
SITE-APPLICANT'S OWNERSHIP

PROPOSED WAYLEAVE OUTSIDE
SITE-APPLICANT'S OWNERSHIP.
(Refer to engineers drawings & key
note plan on CJFA DRG 100 for full
extent services)

WAYLEAVE AREA:
A - 0.022 Ha
B - 0.226 Ha
Total - 0.248 Ha

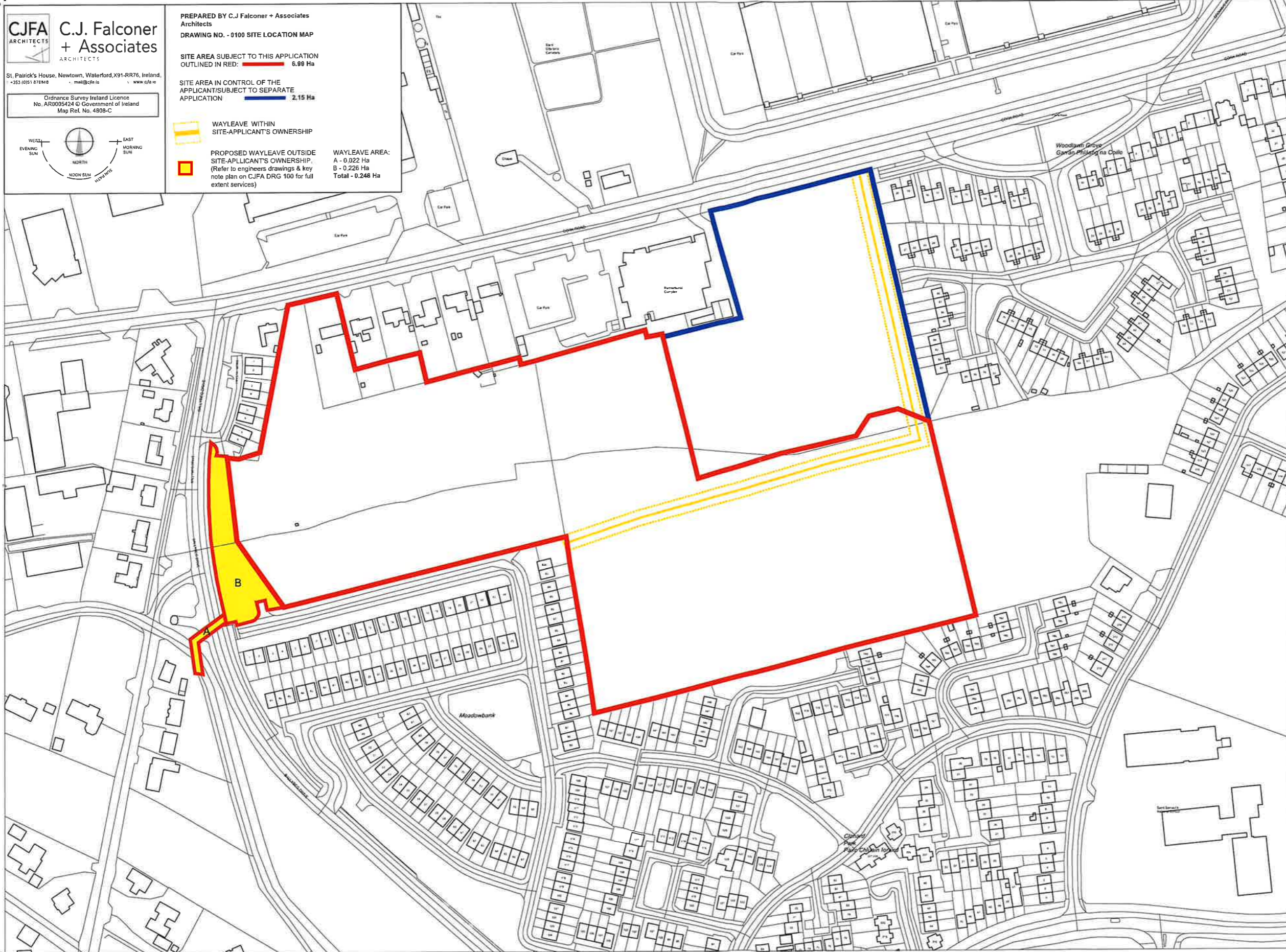

Description:

Digital Landscape Model (DLM)

Publisher / Source:

Ordnance Survey Ireland (OSi)

Data Source / Reference:

PRIME2

File Format:

Autodesk AutoCAD (DWG_R2013)

File Name:

v_50330797_1.dwg

Clip Extent / Area of Interest (AOI):

LLX,LLY= 657588.4504,610064.5491

LRX,LRX= 658418.4504,610064.5491

ULX,ULY= 657588.4504,610679.5491

URX,URY= 658418.4504,610679.5491

Projection / Spatial Reference:

Projection= IREN95_Irish_Transverse_Mercator

Centre Point Coordinates:

X,Y= 658003.4504,610372.0491

Reference Index:

Map Series | Map Sheets

1:1,000 | 5701-13

1:1,000 | 5701-14

1:2,500 | 5701-C

1:2,500 | 5701-D

Data Extraction Date:

Date= 25-Apr-2023

Source Data Release:

DCMLS Release V1.162.115

Product Version:

Version= 1.4

License / Copyright:

Ordnance Survey Ireland 'Terms of Use' apply.

Please visit www.osi.ie/about/terms-conditions.

© Ordnance Survey Ireland, 2023
Compiled and published by Ordnance Survey
Ireland, Phoenix Park, Dublin 8, Ireland.

Unauthorised reproduction infringes Ordnance
Survey Ireland and Government of Ireland
copyright.

All rights reserved. No part of this publication
may be copied, reproduced or transmitted in any
form or by any means without the prior written
permission of the copyright owners.

The representation on this map of a road, track
or footpath is not evidence of the existence of a
right of way.

Ordnance Survey maps never show legal
property boundaries, nor do they show ownership
of physical features.

© Suirbhéireacht Ordánais Éireann, 2023
Arna thionsú agus arna fhoilsiú ag
Suirbhéireacht Ordánais Éireann, Páirc an
Fhionnuisce, Baile Átha Cliath 8, Éire.

Sáraitonn atáirgeadh neamhdaraithe cóipcheart
Shuirbhéireacht Ordánais Éireann agus Rialtas
na hÉireann.

Gach cead ar cosnamh. Ní ceadmhadh aon
chuid den fhoilseachán seo a chóipeáil, a
atáirgeadh nó a tharchur in aon foirm ná ar aon
bhealach gan cead i scríbhinn roimh ré ó úinéirí
an chóipchirt.

Ní hionann bóthar, bealach nó cosán a bheith ar
an léarscáil seo agus fianaise ar chead slí.

Ní thaispeánann léarscáil seo chuid Ordánais
Shuirbhéireacht na hÉireann teorann phointí
deathúil de mhachn riamh, ná úinéireacht de
ghnéithe fhisiciúla.

